

微型充气泵KPV45A-12B

產品照片 Photo:

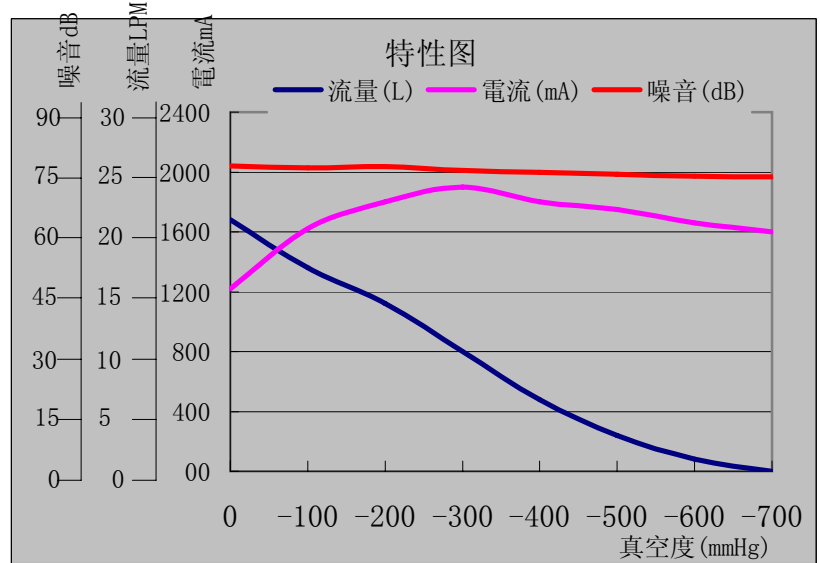

特性曲綫圖 Characteristic Curve:



產品尺寸: Dimension

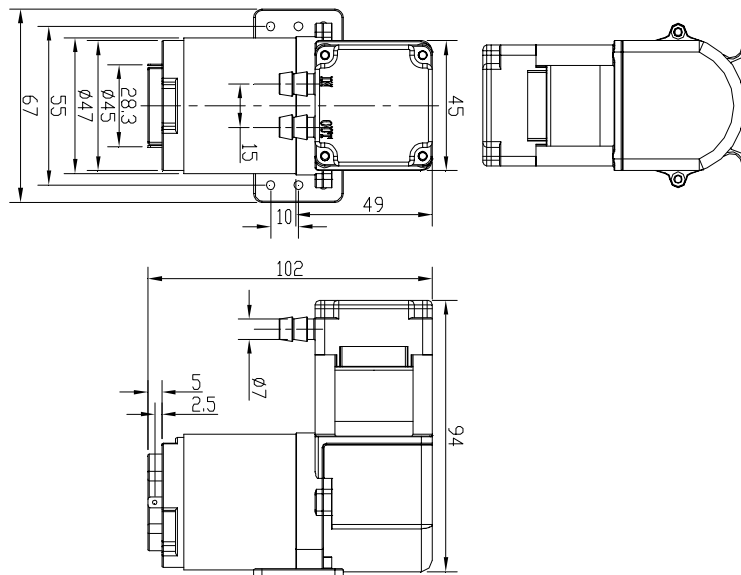

Unit: mm

產品特性: Characteristic

- |                                      |  |
|--------------------------------------|--|
| 1. 定格電壓 Rated Voltage                | DC 12.0 $\pm$ 1% V                             |
| 2. 使用電壓範圍 Range of Operating Voltage | DC 10.8 V ~ 13.2 V                             |
| 3. 定格電流 Rated Current                | <2600mA  |
| 5. 消費功率 Power Consumption            | 31.2W  |
| 6. 使用流体 Fluid Applied                | Air  |
| 7. 氣嘴口徑 Outlet Port O.D.             | 7.0mm  |
| 8. 真空流量 Vacuum Air Flow              | >18LPM   |
| 9. 最低使用電壓 Restart Voltage            | 10.8V  |
| 10. 噪音 Noise                         | <85dB (30cm away)                              |
| 11. 壽命 Life                          | 100,000 times (on 4sec, off 4sec as one cycle) |