

真空泵KPV30A-12A

產品照片 Photo:

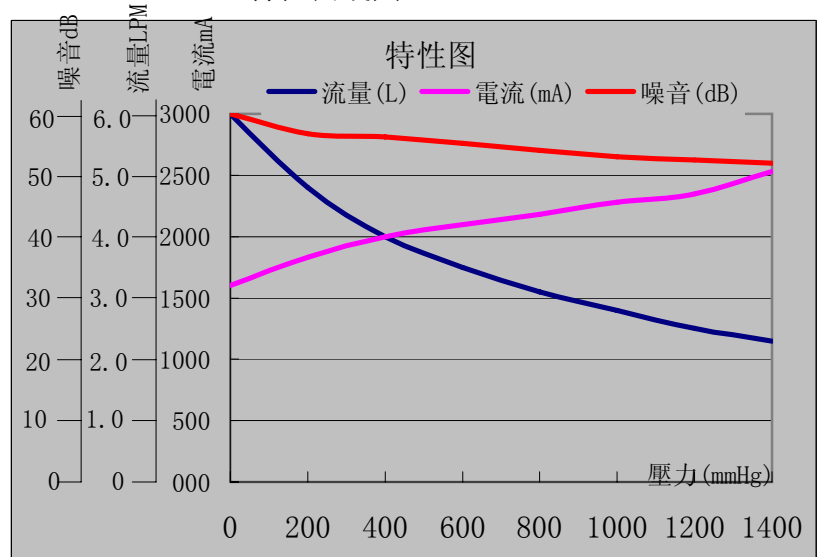

特性曲綫圖 Characteristic Curve:



產品尺寸: Dimension

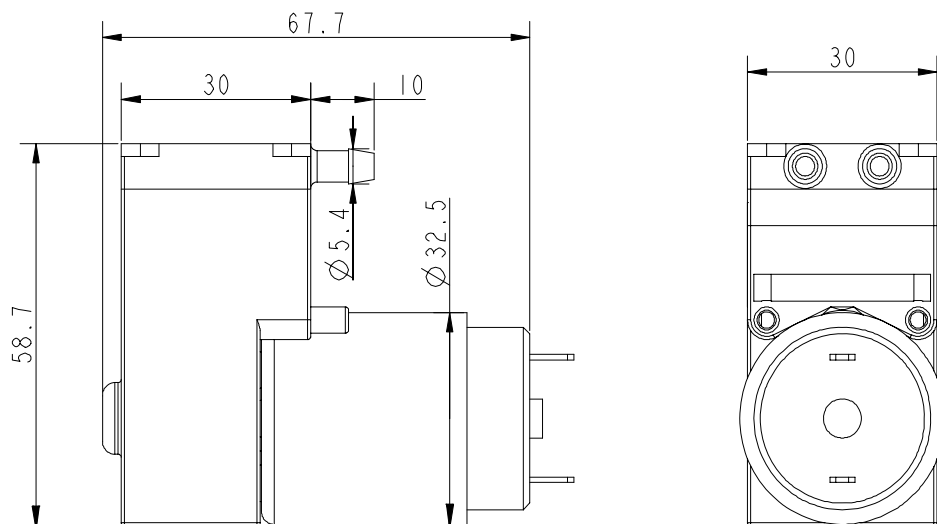

Unit: mm

產品特性: Characteristic

- | | |
|--------------------------------------|-------------------|
| 1. 定格電壓 Rated Voltage | DC12.0V |
| 2. 使用電壓範圍 Range of Operating Voltage | DC10.8 V ~ 13.2 V |
| 3. 定格電流 Rated Voltage | <1500mA |
| 5. 消費功率 Power Consumption | 18W |
| 6. 使用流体 Fluid Applied | Air |
| 7. 氣嘴口徑 Outlet Port O.D. | 5.4mm |
| 8. 流量 Air Flow | >6LPM |
| 9. 最大真空度 Maximum Vacuum | >1800mmHg |
| 10. 最低使用電壓 Restart Voltage | 10.8V |
| 11. 噪音 Noise | <75dB (30cm away) |
| 12. 壽命 Life | 2000Hr |